

LAMPA OŚWIETLENIA WNĘTRZA INTERIOR LIGHT

ŚRODEK ODNIESIENIA
CENTER OF THE REFERENCE

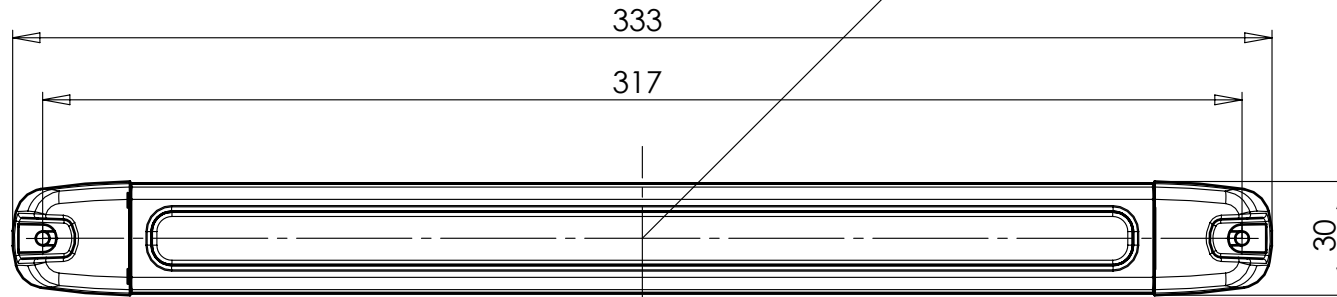

OŚ ODNIESIENIA
AXIS OF THE REFERENCE

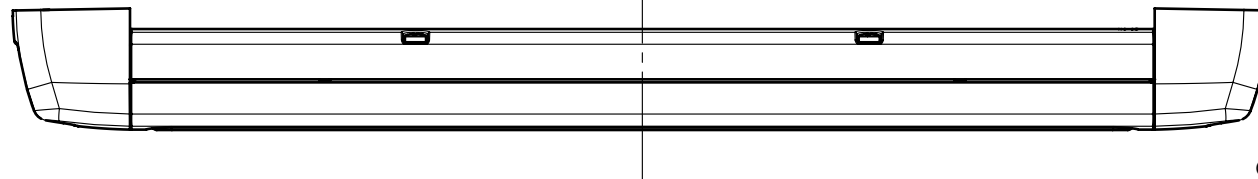
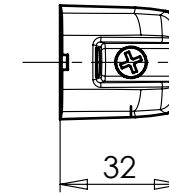

OTWORY W NADWOZIU DO MOCOWANIA
FIXING OPENINGS IN THE CARRIAGE

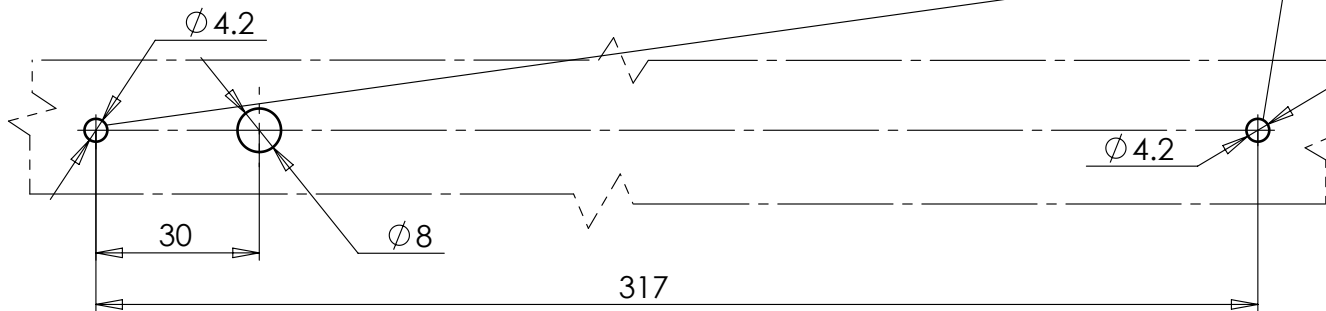

| | |
|--|---------------------------|
| Napięcie zasilania Supply voltage | 12Vdc |
| Zakres napięć zasilania Voltage range | 10,5 – 14,9Vdc |
| Prąd zasilania Operating current | 0,28A @ 13,5V |
| Temperatury pracy Operating temperature | -40C to +50C |
| Waga Weight | 162 g |
| Wymiary Dimensions | 333mm x 30mm x 32mm |
| Zastosowane LED LED | 3 x 80 lumen |
| Zasilanie Colours of wires | czarny +Vdc; biały – masa |